



# Grove Road

The Mounts, Northampton

**oriordanbond**  
SALES & LETTINGS





GROUND FLOOR  
721 sq.ft. (67.0 sq.m.) approx.

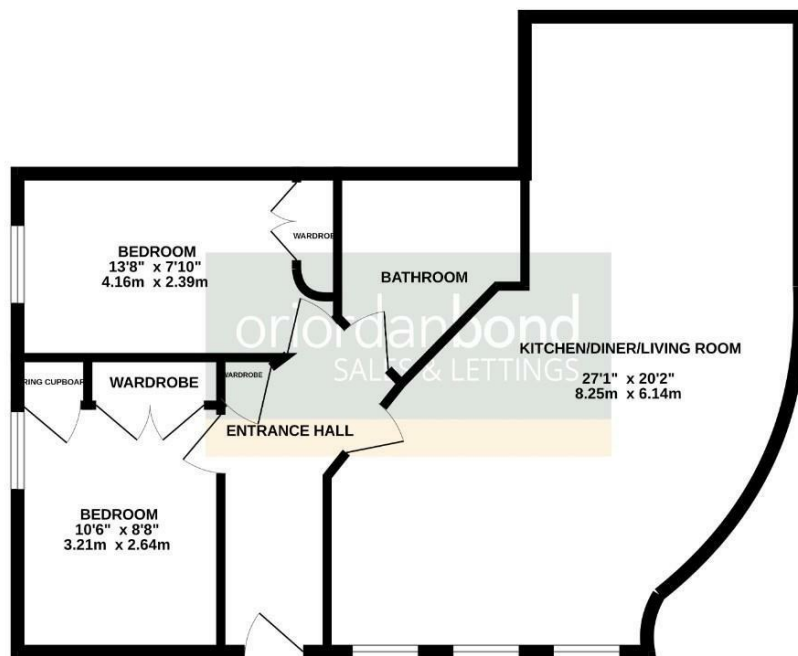

TOTAL FLOOR AREA : 721 sq.ft. (67.0 sq.m.) approx.  
Whilst every attempt has been made to ensure the accuracy of the floorplan contained here, measurements of doors, windows, rooms and any other items are approximate and no responsibility is taken for any error, omission or mis-statement. This plan is for illustrative purposes only and should be used as such by any prospective purchaser. The services, systems and appliances shown have not been tested and no guarantee as to their operability or efficiency can be given.  
Made with Netragon CSD25

## Grove Road

The Mounts

NN1 3LG

OFFERS OVER £150,000

O'Riordan Bond is thrilled to offer for sale this impressive two bedroom ground floor maisonette located at the front of this landmark development, The Plaza. This former historic cinema was converted in 2006 and is located within walking distance of the town centre and also comes with allocated secure parking.

The accommodation comprises entrance hall, large open plan kitchen/living space, two double bedrooms with built-in wardrobes and a three-piece bathroom. Benefits include integrated appliances in the kitchen, gas radiator heating and oak flooring. (B/721/-)

Leasehold Information: Lease Remaining - 106 years (as of 2025) / Ground Rent - £150 per annum (includes water) / Service Charge - £TBC

### Additional information

- Council Tax Band: C
- Energy Efficiency Rating: C

### Viewing

Viewing strictly by appointment – details below

### Disclaimer

O'Riordan Bond Estate Agents Limited has not tested apparatus, equipment, fittings or services and so cannot verify they are in working order. The buyer is advised to obtain verification from their solicitor or surveyor.

O'Riordan Bond Abington Sales

01604 639007

abington@oriordanbond.co.uk

